



Cre8Play's unique Mono Play Mound allows for 360 degrees of climbing play. Specially designed to accommodate either Poured in Place rubber surfacing, (PIP), or Synthetic Turf. Manufactured with a coating of Glass Fiber Reinforced Concrete, (GFRC), for durability and a sturdy base for surfacing.



L: 7' 6"  
W: 7' 6"  
H: 1' 6"  
360 LBS

DOES NOT INCLUDE SURFACING  
MOUND ONLY  
(Appx. 50 square feet of surfacing required)

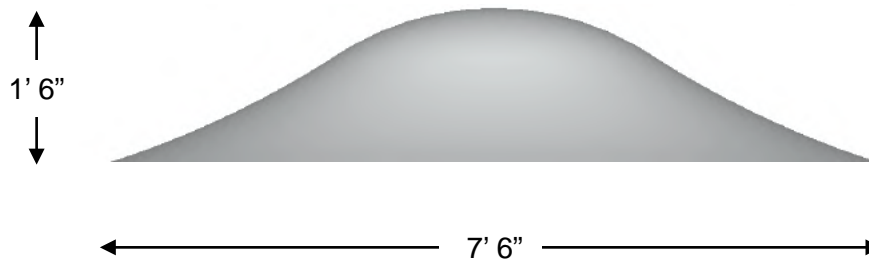
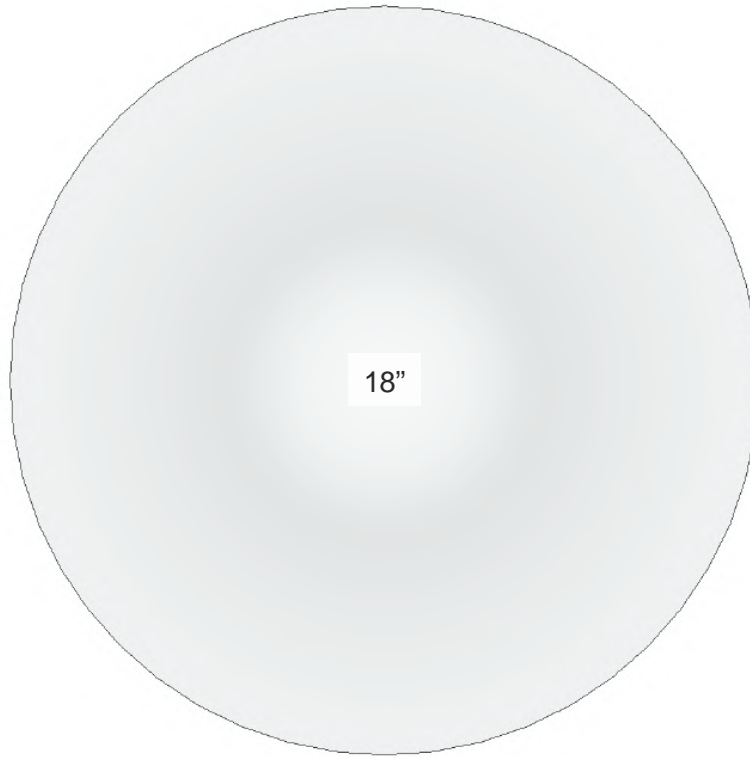

4" CONCRETE SLAB OPTION

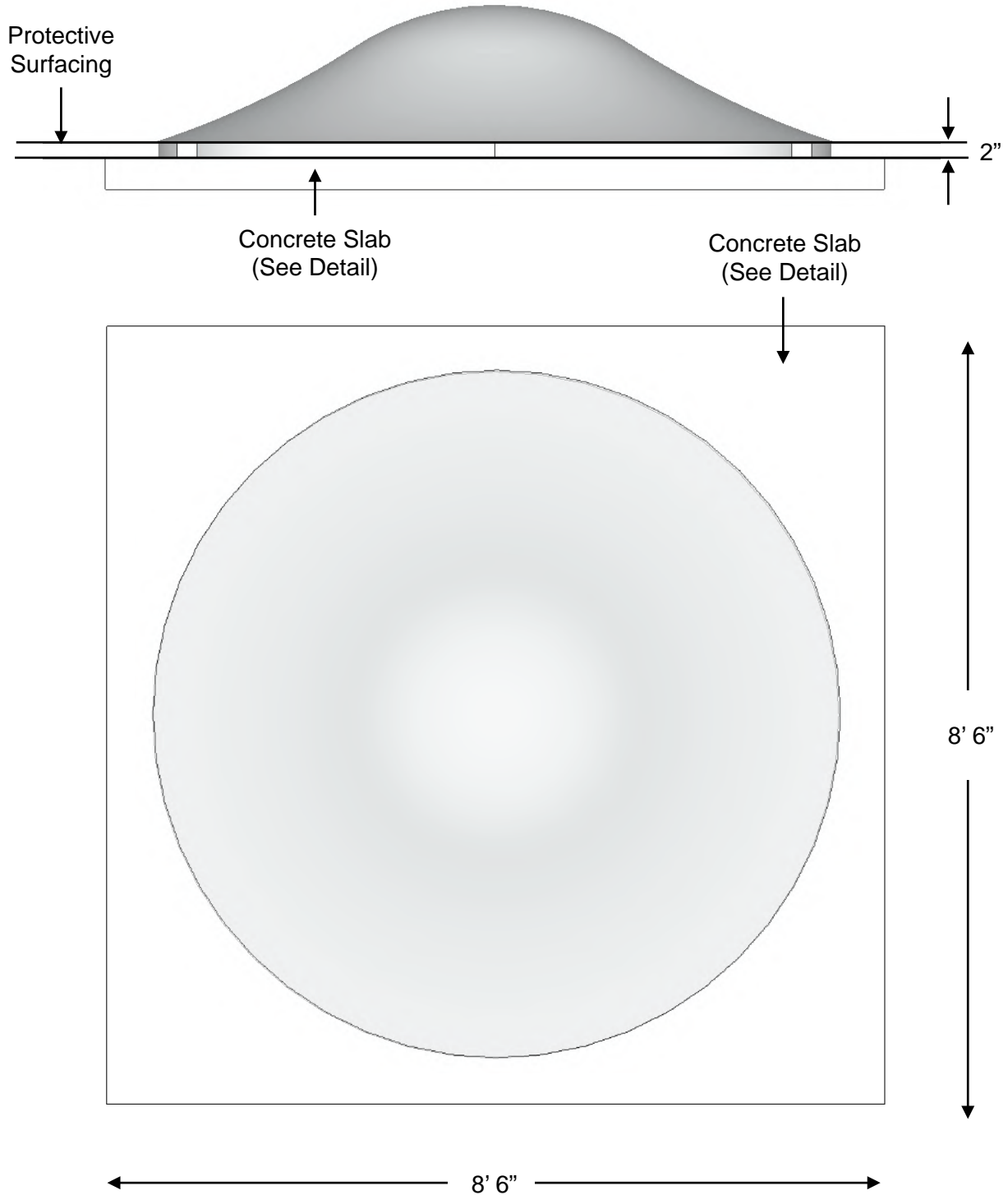

4" CONCRETE SLAB OPTION

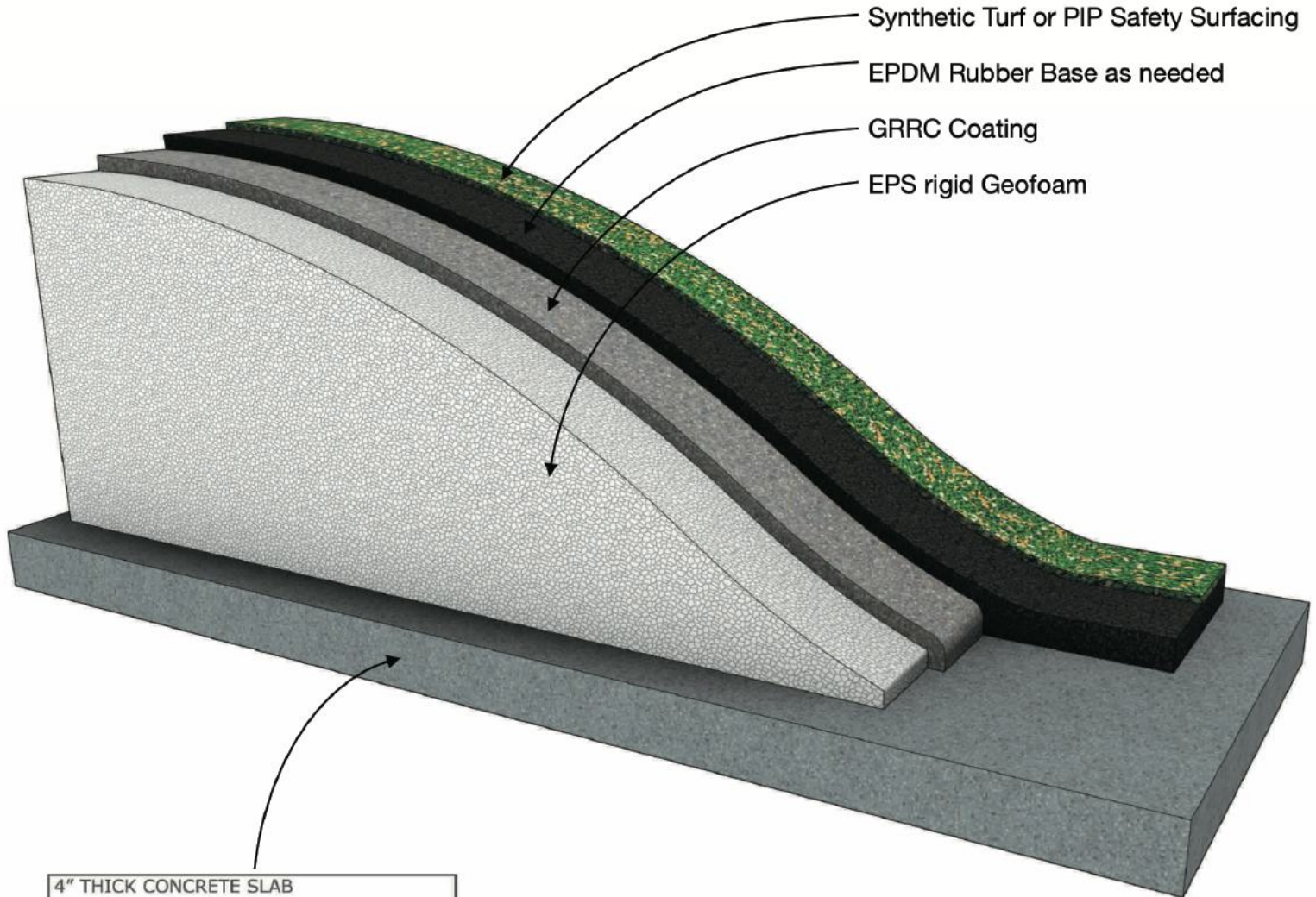

- Synthetic Turf or PIP Safety Surfacing
- EPDM Rubber Base as needed
- GRRC Coating
- EPS rigid Geofoam

4" THICK CONCRETE SLAB  
TYPICAL (VERIFY FOR LOCAL CONDITIONS)  
MIN 3,500 PSI CONCRETE WITH  
6 X 6 WIRE MESH W2.9 X W2.9 W.W.F.  
FLAT SHEETS, CENTERED IN THE SLAB  
-OR-  
FIBER REINFORCED CONCRETE MIX  
EQUIVALENT IN STRENGTH TO  
MIN 3,500 PSI CONCRETE WITH  
6 X 6 WIRE MESH W2.9 X W2.9 W.W.F.  
FLAT SHEETS, CENTERED IN THE SLAB  
(BY OTHERS)

Surfacing provided by others

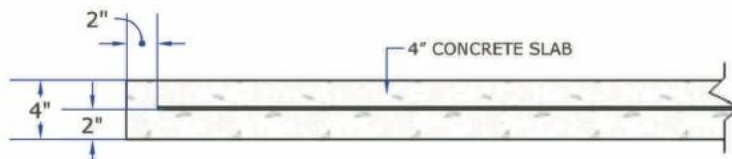

6" AGGREGATE BASE OPTION

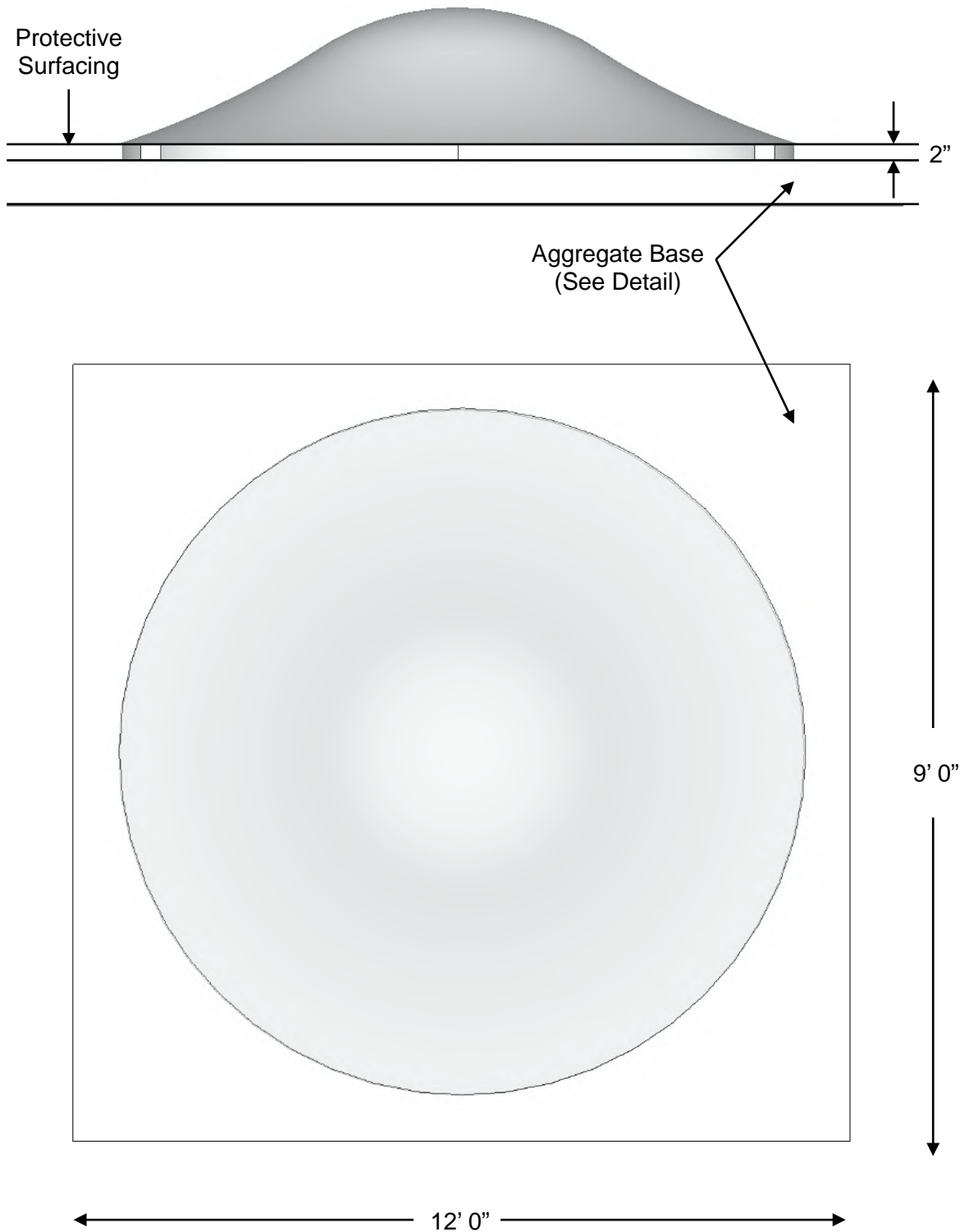

6" AGGREGATE BASE OPTION

Surfacing provided by others

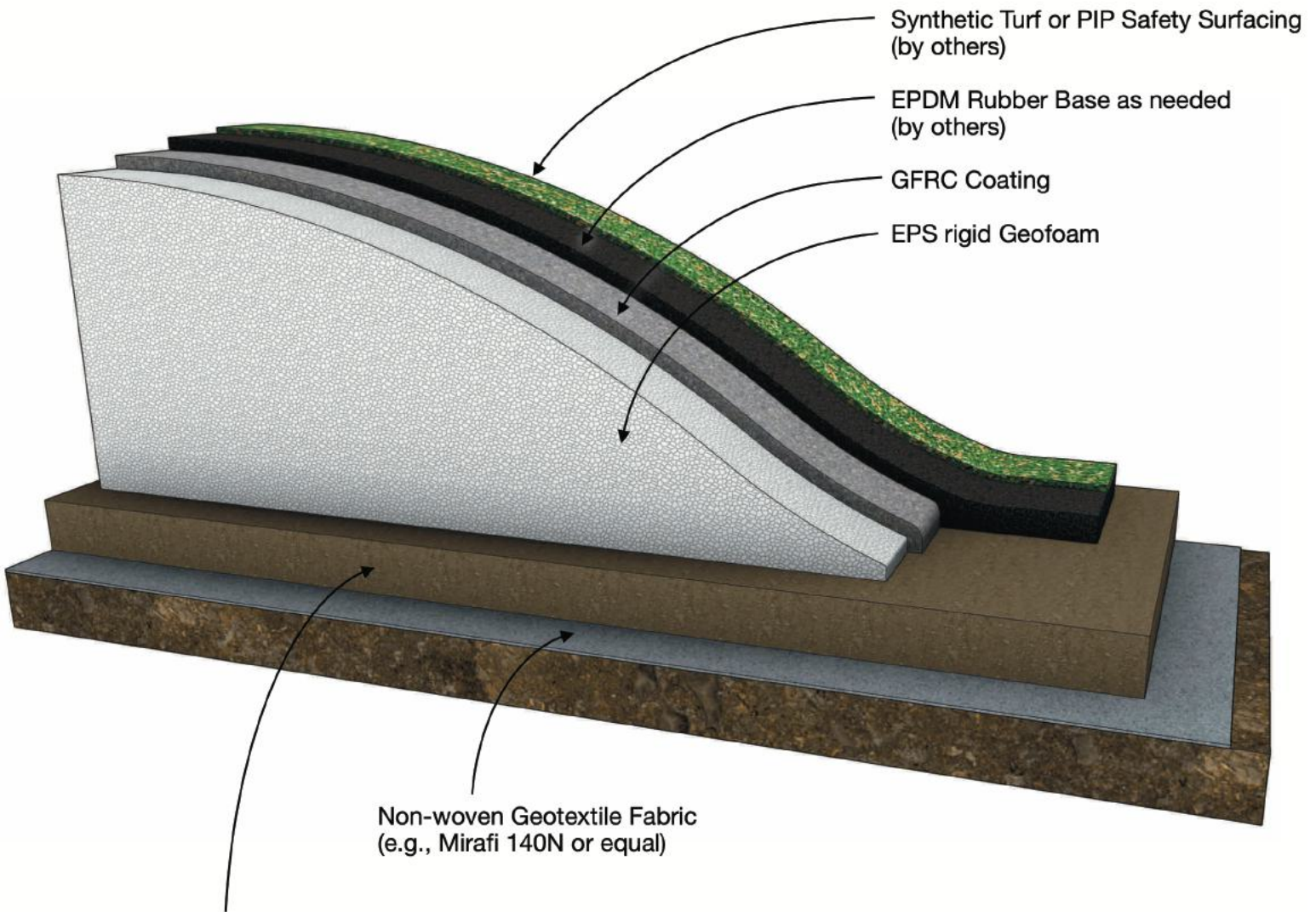

Provide a 6" thick compacted crushed aggregate base consisting of 3/4" minus angular stone with fines (ASTM D2940). Compact in maximum 4" lifts to 95% Standard Proctor density. Ensure proper drainage and place over a proof-rolled subgrade.

**NOTE: Read installation instructions thoroughly before starting installation process.**

**Step 1:** Lay out the area and prepare the site for install. Concrete must be installed over a solid, level base. Check local soil condition and codes.

**Step 2:** Pour a concrete base for the components. If choosing the aggregate base option, then properly prepare the aggregate base as specified. Refer to the typical concrete sections in this document. The concrete should be flush with the ground level. Allow time for the concrete to completely cure before continuing.

**Step 3:** Measure a centerline before placing the first component. (See image below, Step 3.).

**Step 4:** Locate FOAM-1. Align with the centerline leaving a 6" minimum gap between the edge of the concrete slab and Foam-1 (See image below, Step 4.). Using the supplied adhesive (hardware kit HK146), glue the foam to the concrete. With the dispensing gun fully open, dispense foam with a continuous bead.

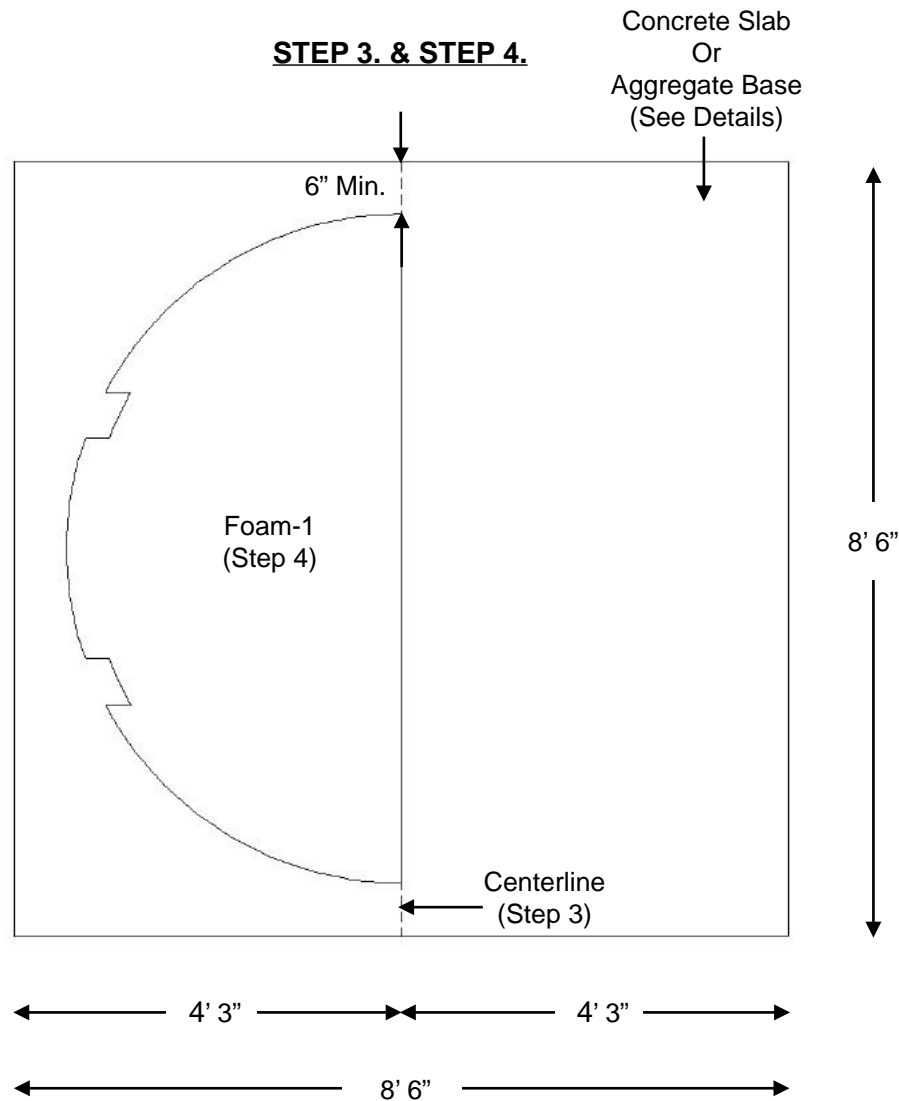

**NOTE: Read installation instructions thoroughly before starting installation process.**

**Step 5:** Locate FOAM-2. Align FOAM-2 with FOAM-1 ensuring the seams are flush with each other (See image below, Step 5.). Using the supplied adhesive (hardware kit HK146), glue the FOAM-2 to FOAM-1, and to the concrete. With the dispensing gun fully open, dispense foam with a continuous bead. For foam to foam, apply the beads in rows, 4 inches apart.

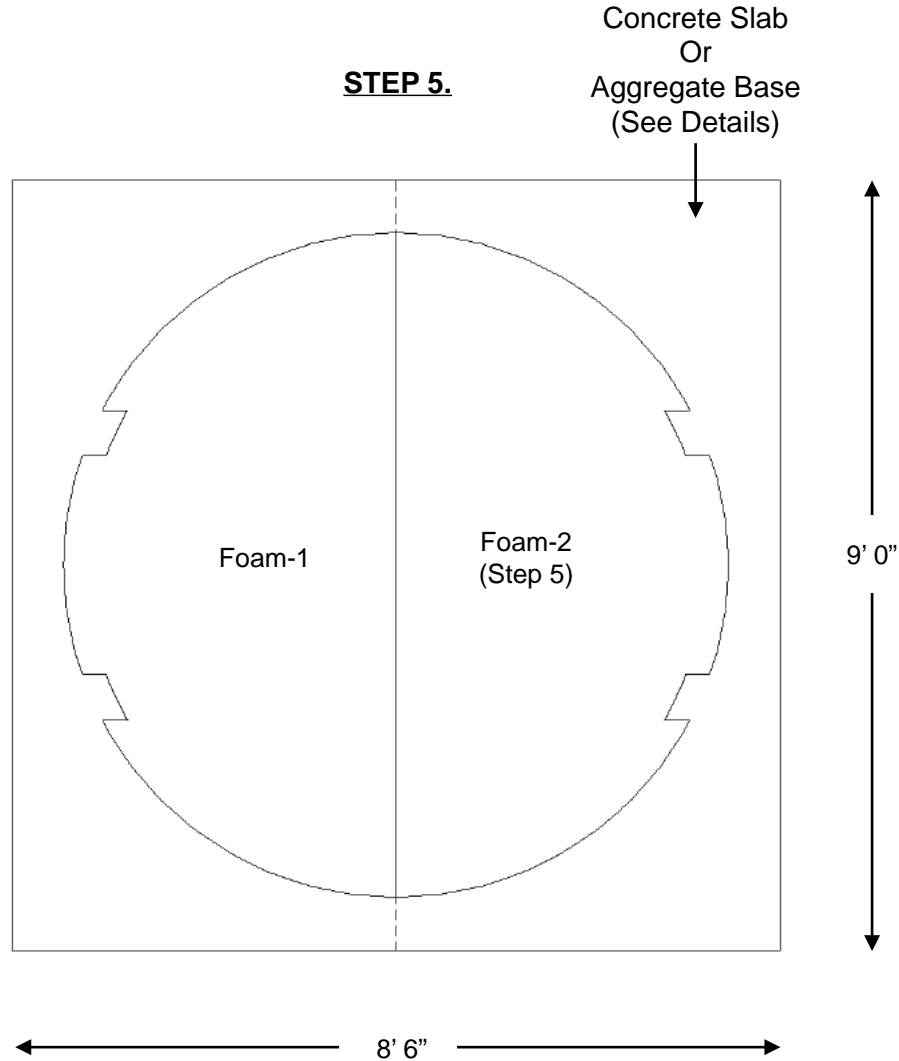

**NOTE: Read installation instructions thoroughly before starting installation process.**

**Step 6:** Fill all open fork pockets with the foam fillers provided, (glue, cut, & shape) using hardware kit HK146.

**Step 7:** Install the turf or PIP surfacing to the Mono Play Mound. Install the approved impact attenuating play surface around the component. Refer to the surfacing manufacturer for installation of an approved impact attenuating play surface around the component.

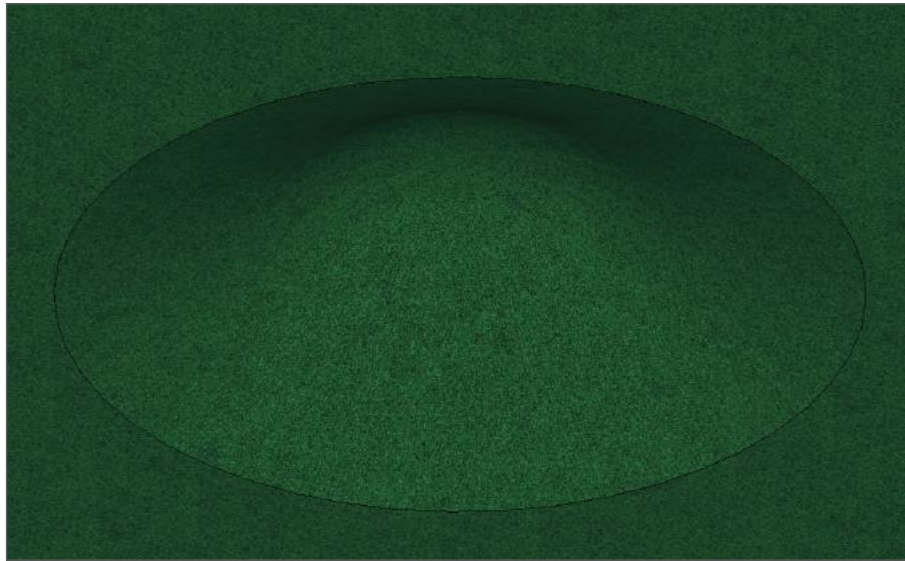

**STEP 7.**

**Included Items:**

Part #	Item	Description	Quantity
90002S	Play Mound Foam Unit	Play Equipment	2
90002S	Play Mound Foam Fillers	3" x 6" x 4'-0" EPS Foam	1
HK146	5631573	Urethane Adhesive	1
HK146	FG250002	Adhesive Dispensing Gun	1